

Photovoltaic panel installation line group

Scooter battery

The battery is installed in the pedal



Built-in battery in car beam

The battery is installed in the car beam



Pack the battery in the box

This the battery installation box, replace the battery core without changing the shell



Ebike battery

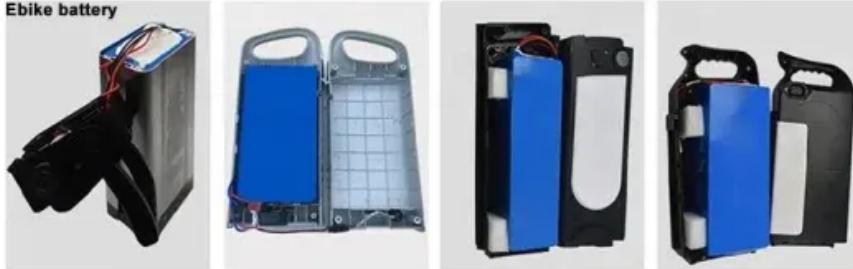

Overview

There are two basic approaches to connecting a grid-tied solar panel system, as shown in the wiring diagrams below. Here are design tips for methods of PV system utility interconnection. The utility connection for a PV solar. However, just because connecting multiple PV modules together to create a solar panel array is relatively straightforward, it's absolutely essential that you get it right. Wiring solar panels together incorrectly can lead to damaging or destroying valuable components — it can even be. Creating a compliant pv system single-line diagram (SLD) is a critical skill for any electrician working in solar. Did you know that incorrect photovoltaic panel wiring can reduce system efficiency by up to 30%?

With solar installations increasing by 40% year-over-year (2024 SolarTech Market Report), understanding wiring diagrams isn't just technical jargon—it's money-saving mastery. In some meter-main configurations, the feed through lugs go to a main lug only (MLO) panel which makes things interesting.

Photovoltaic panel installation line group



PV Interconnection: Load-Side vs. Line-Side

Solar installers and professionals must understand permitting and compliance policies when interconnecting a photovoltaic energy installation to the grid. This article provides insight into different ...

How to Create a Single-Line Diagram for a PV System ...

A practical guide for creating a clear and compliant single-line diagram (SLD) for a solar PV system, a critical component for permitting and installation.



Photovoltaic Panel Line Grouping: The Secret Sauce for Solar Efficiency

That's exactly what happens in photovoltaic panel line grouping when modules aren't properly matched. As solar installers chase higher efficiency ratings, the real magic happens not in individual panels, ...

Solar Interconnection Methods (Full Guide)

A line side tap (or supply side tap) refers to a connection between the meter and main breaker. This is the preferred method of interconnection for solar installers as it is the most straight ...



The Complete Guide to Solar Panel Wiring Diagrams

Read on to find out more about solar panel connection diagrams and how to wire PV modules to achieve the best performance based on your unique installation requirements.

What is a Single Line Diagram (SLD)?

Single line diagrams (SLDs) are simplified graphical representations of electrical systems, showing components, connections, and power flow. Solar panel sets are integral for any PV (Photovoltaic) ...



How to connect a PV solar system to the utility grid

There are two basic approaches to



connecting a grid-tied solar panel system, as shown in the wiring diagrams below. The most common is a "LOAD SIDE" connection, made AFTER the main breaker. ...

Photovoltaic panel single group installation skills diagram

Follow these detailed steps to draw a comprehensive single-line diagram for a solar installation system that includes a PV array, a battery backup, and a standby generator: Step 1: Layout and Design the ...



How to Group Photovoltaic Panels: Wiring Diagrams and Optimization

Well, there you have it--the not-so-secret sauce behind efficient photovoltaic panel wiring diagrams. Remember, it's not just about following schematics blindly, but understanding the ...

Solar Panel Wiring Basics: How to Wire Solar Panels

Master solar panel wiring with this in-depth guide. Learn how to configure series and parallel connections, calculate voltage and current, and safely integrate inverters, charge controllers, and ...



Contact Us

For catalog requests, pricing, or partnerships, please visit:
<https://www.kidsandparents.pl>

