

What is the photovoltaic panel area



What is the photovoltaic panel area



How much area does each solar photovoltaic panel have?

To determine the area covered by each solar photovoltaic panel, several factors come into play, including the type of panel, the manufacturer, and its specific capacity.

Exploring Solar Panel Area: Key Considerations and Impact

Solar panel area refers to the total surface area occupied by solar panels installed to capture sunlight for energy conversion. This area is typically measured in square meters and is directly correlated with ...



Photovoltaic Panel Array Area Calculation: A No-Nonsense Guide for

Let's cut through the jargon: calculating photovoltaic panel array area isn't just about ruler measurements. It's like playing 3D chess with sunlight, shadows, and your wallet.

How to Calculate the Surface Area Required by Solar Panels

But wait, are you sure you have enough space in your garden or your backyard or your rooftop to install the solar panels? How can you do a rough estimate of the area required by the solar ...



A Guide on Calculating Area Required for Solar Panel Installation

Each solar panel requires approximately 18 sq. ft. space. Thus, for installing 20 solar panels on the ground, you will require 360 square feet of shade-free area.

Solar Panel Calculator

Calculate Total Solar Panel Area (m²):
Once you know the total power, divide it by the power and area of a single solar panel to find out how many panels and how much space you need.



We Analyzed 100 Solar Panels: Dimensions, Efficiency, & Load

Dimensions and Area: The dimensions of each solar panel model are listed in



millimeters, along with the calculated area in square meters. Looking at the "Dimensions (mm)," "Area (m²)," and "Power Range ...

Total Area Required for Solar Panel Installation Calculator

Calculate the total area needed for your solar panel installation quickly and accurately with our easy-to-use solar panel area calculator.

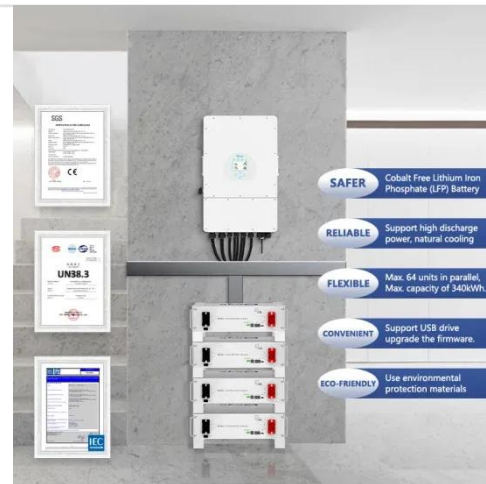

How much area is needed for solar panel installation

A typical home solar panel is about 3 feet wide by 5.5 feet long, occupying an area of roughly 17.5 square feet (sq ft). On average, the amount of required roof space for a set of home ...

PVWatts Calculator

NREL's PVWatts ® Calculator Estimates the energy production of grid-connected photovoltaic (PV) energy systems throughout the world. It allows

homeowners, small building owners,
installers and ...



Contact Us

For catalog requests, pricing, or partnerships, please visit:
<https://www.kidsandparents.pl>

